

620 TERMINAL WAY • P. O. BOX 938 • COSTA MESA, CALIFORNIA 92627 • (714) 642-1163

IMPORTANT: AN "N" SERIES QUICK SPOOL WILL NOT FIT THIS REEL.

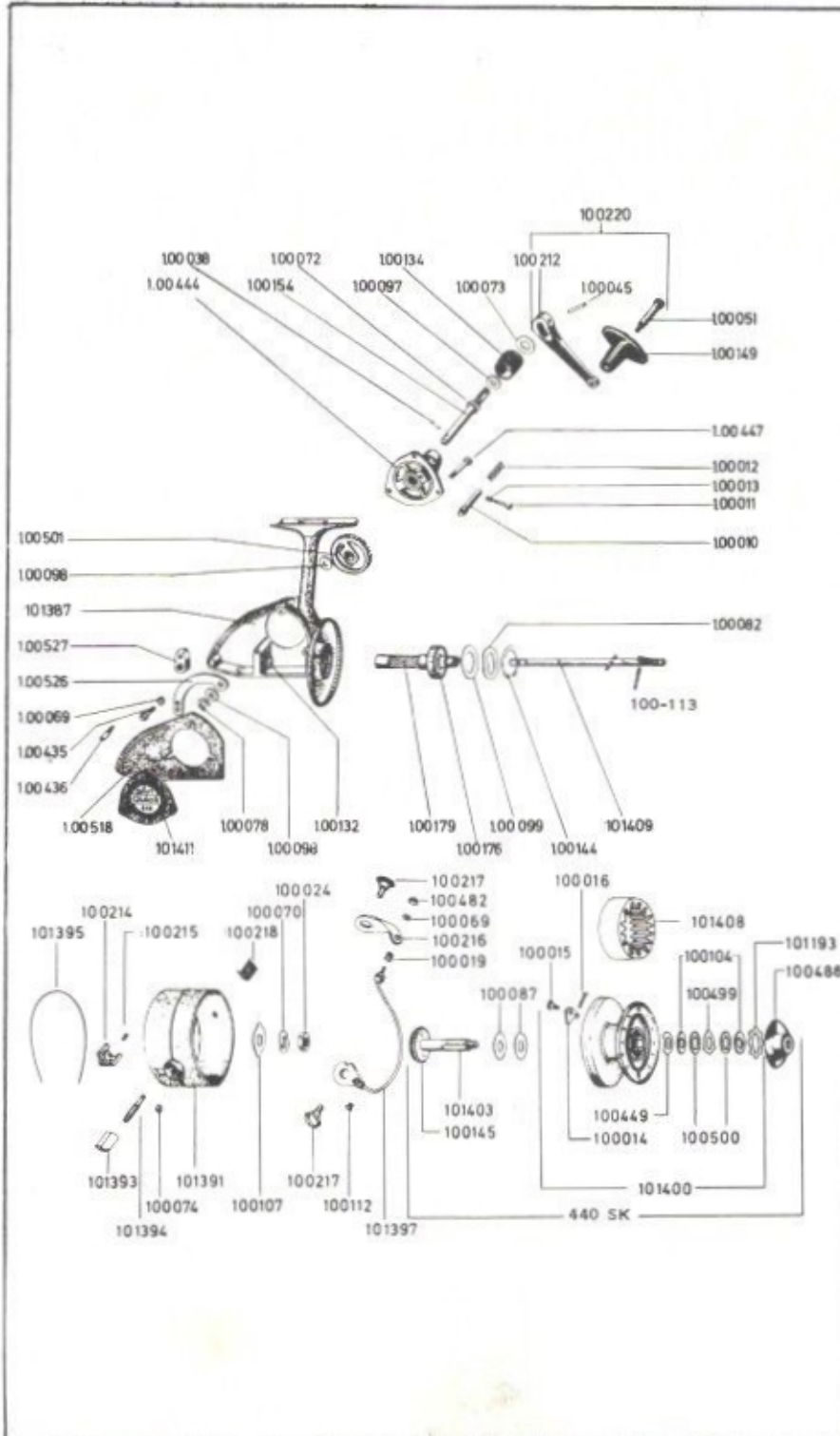

| PART NO. | DESCRIPTION | PRICE LIST | QTY |
|----------|-----------------------------|------------|-----|
| 100-010 | Anti-reverse pin | .55 | |
| 100-011 | Ball lever | .45 | |
| 100-012 | Spring | .25 | |
| 100-013 | Plastic tubing | .25 | |
| 100-014 | Click tongue | .30 | |
| 100-015 | Pin | .25 | |
| 100-016 | Spring | .30 | |
| 100-019 | Line guide | 2.45 | |
| 100-024 | Hexagon nut | .30 | |
| 100-038 | Pin for drive gear | .30 | |
| 100-045 | Pin for crank arm | .30 | |
| 100-051 | Grip screw | .40 | |
| 100-069 | Lock washer | .30 | |
| 100-070 | Spring washer | .25 | |
| 100-072 | Safety clip | .25 | |
| 100-073 | Washer | .25 | |
| 100-074 | Safety clip | .30 | |
| 100-078 | Safety clip | .25 | |
| 100-082 | Spring washer | .25 | |
| 100-087 | Washer (resitex) | .25 | |
| 100-097 | Washer | .25 | |
| 100-098 | Washer | .25 | |
| 100-099 | Packing ring | .25 | |
| 100-104 | Washer (metal) | .30 | |
| 100-107 | Driving plate | .30 | |
| 100-112 | Cover cap | .30 | |
| 100-113 | Axle spool catch | .25 | |
| 100-132 | Bearing bushing for housing | .40 | |
| 100-134 | Crank nut | .70 | |
| 100-144 | Snap ring | .25 | |
| 100-145 | Ratchet wheel | .35 | |
| 100-149 | Handle grip | .40 | |
| 100-154 | Driving axle | 1.45 | |
| 100-176 | Ball bearing | 3.00 | |
| 100-179 | Drive shaft | 2.50 | |
| 100-212 | Crank arm | 1.90 | |
| 100-214 | Switching piece | .40 | |
| 100-215 | Threaded pin | 1.05 | |
| 100-216 | Angle lever | 1.20 | |
| 100-217 | Bearing screw | .55 | |
| 100-218 | Ball spring | .40 | |
| 100-220 | Crank arm, complete | 2.80 | |
| 100-435 | Screw for slide | .25 | |
| 100-436 | Screw for axle | .25 | |
| 100-444 | Bearing cover | 1.90 | |
| 100-447 | Screw for bearing cover | .25 | |
| 100-449 | Spring ring | .25 | |
| 100-482 | Hexagon nut | .30 | |
| 100-488 | Drag nut | 1.45 | |
| 100-499 | Driving plate | .25 | |
| 100-500 | Washer | .25 | |
| 100-501 | Drive gear | 2.05 | |
| 100-518 | Housing cover | .65 | |
| 100-526 | Slide | .55 | |
| 100-527 | Connecting piece | .45 | |
| 101-193 | Toothed washer | .25 | |
| 101-387 | Housing | 5.35 | |
| 101-391 | Rotating head | 5.35 | |
| 101-393 | Guide block | .55 | |
| 101-394 | Stop screw | .40 | |
| 101-395 | Stop slide spring | .30 | |
| 101-397 | Bail | 3.00 | |
| 101-403 | Break spindle | 2.30 | |
| 101-408 | Ring for spool | .50 | |
| 101-409 | Axle, complete | 2.20 | |
| 101-411 | Side plate cover | 1.80 | |
| 440SK | Spool, complete | 9.50 | |